

DEPOT CENTER

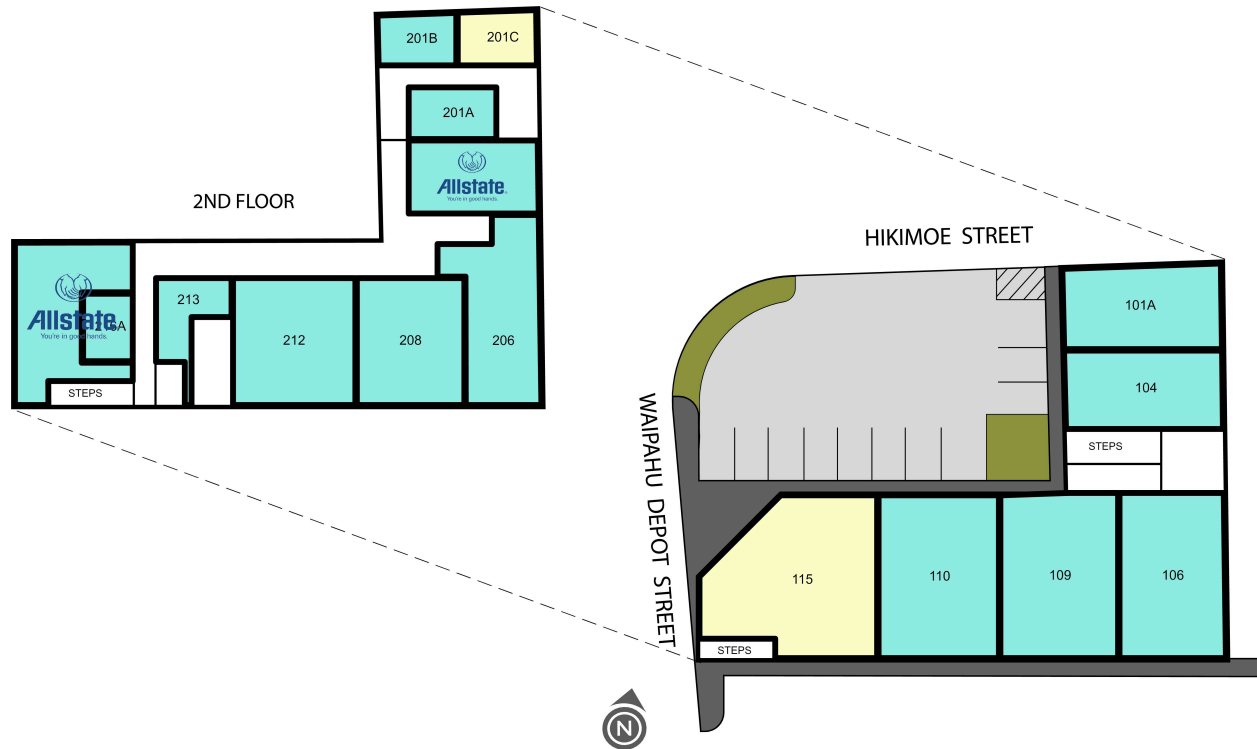

| | | | |
|--|----------|---------------------------------|--------|
| 101A NURSE PRO-CARE | 640 SF | 201C AVAILABLE | 319 SF |
| 104 RONALD C. RAVELO | 710 SF | 204 Allstate | 600 SF |
| 106 MARY DARLENE TOM AND HOWARD F. NEUDORF | 580 SF | 206 WILLIAM K. SATO, D.D.S. | 766 SF |
| 109 DENNIS I. MAEHARA, M.D. | 854 SF | 208 TERRI ANDRADE, D.D.S. | 650 SF |
| 110 BUENAVENTURA E. REALICA, M.D. | 854 SF | 212 MARCOS CORPUZ, D.D.S., INC | 982 SF |
| 115 AVAILABLE | 1,265 SF | 213 GLENN M. WATANABE, O.D. | 555 SF |
| 201A INFINITE CARE PLUS | 330 SF | 216 Allstate | 890 SF |
| 201B ANSON O. REGO | 389 SF | 216A MARCOS CORPUZ, D.D.S., INC | 382 SF |