

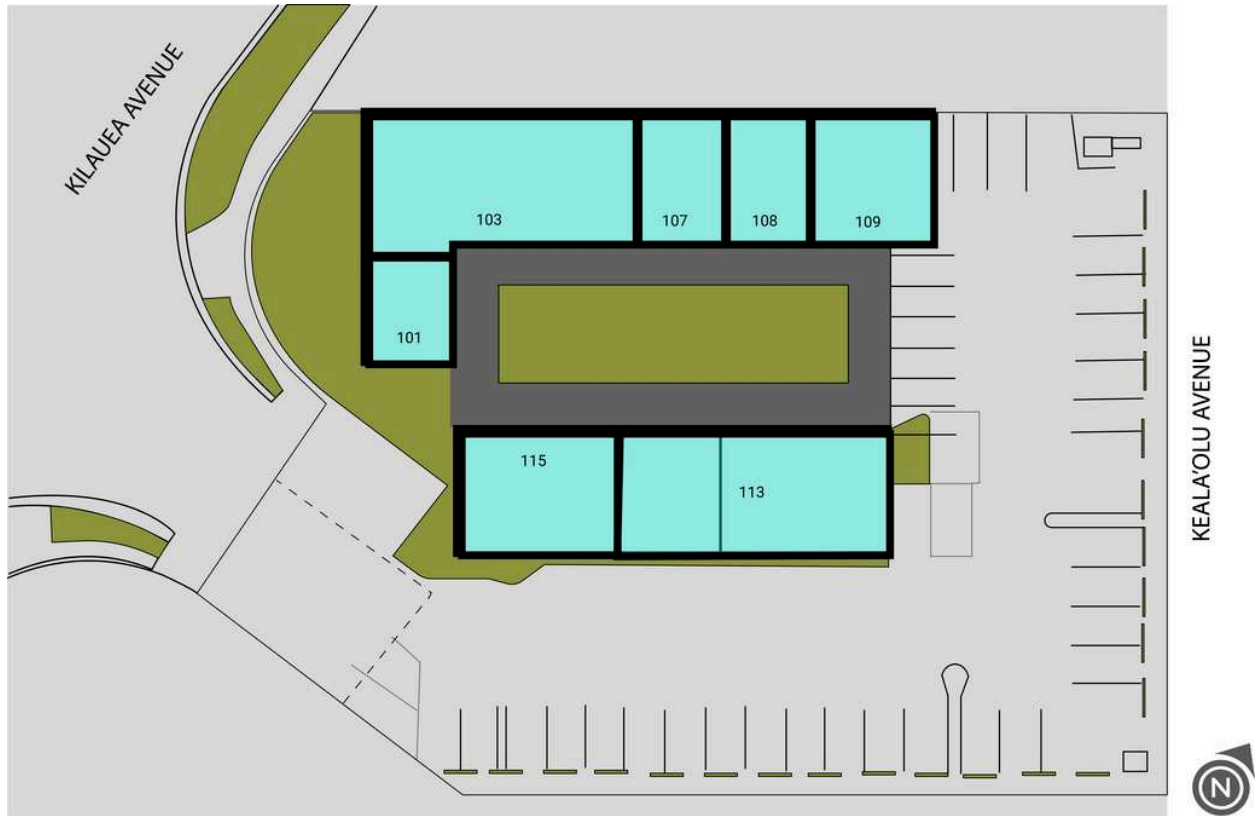

# KĀHALA PROFESSIONAL



|   |        |  |          |
|---|--------|--|----------|
| 101 LANCE I. TERAMOTO DDS                                   | 700 SF | 108 KAHALA MODERN DENTISTRY CORP.            | 360 SF   |
| 103 HAWAII DERMATOLOGY CENTERS INC.                         | 744 SF | 109 KAHALA MODERN DENTISTRY                  | 720 SF   |
| 104 HAWAII DERMATOLOGY CENTERS INC.                         | 356 SF | 113 Landon M Oka DDS LLC                     | 1,080 SF |
| 105 MALIA L. THOMPSON GINOZA TAMMIE A. KIM & SCOTT K.GINOZA | 360 SF | 115 TOMOMI FLEWELLING AND BRANDON FLEWELLING | 720 SF   |
| 107 HAWAII ELITE CHIROPRACTIC                               | 360 SF |  |          |