

# 1336 DILLINGHAM

1336 DILLINGHAM BLVD, HONOLULU, HI 96817

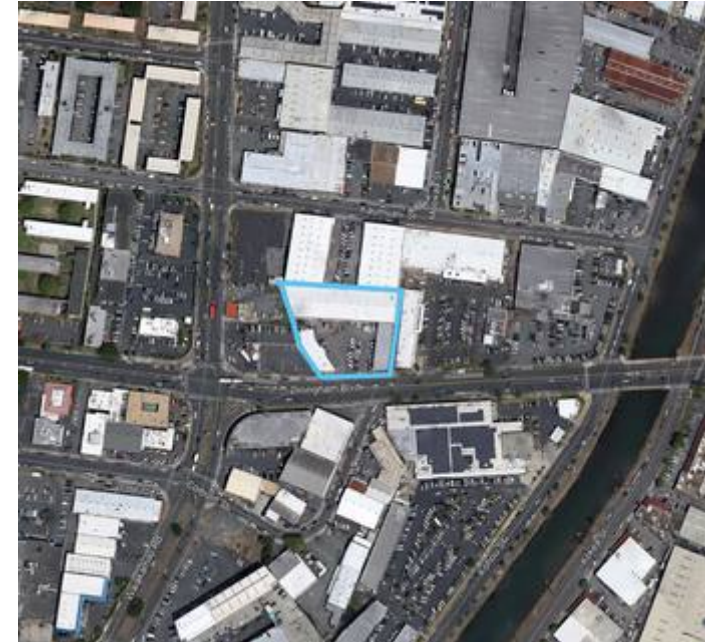

KAMEHAMEHA SCHOOLS®



This multi-tenant property consists of two buildings offering industrial and retail space with associated parking. Warehouse bays at 1336 Dillingham benefits from excellent visibility fronting Dillingham Boulevard and is only 1.9 miles from downtown Honolulu, 2.4 miles from the Honolulu Harbor, and 4.4 miles from Waikīkī. Flexible IMX-1 zoning allows a wide range of uses.

## FOR LEASING INFORMATION

Anthony Provenzano

(808) 544-1780

[aprovenzano@chaneybrooks.com](mailto:aprovenzano@chaneybrooks.com)

GLA	DEMOGRAPHICS	1 MILE	3 MILE	5 MILE
25,844	Population	38,410	178,431	320,847
	Total Households	10,187	64,476	120,074
	Average HouseHold Income	\$78,612	\$94,286	\$95,985

# 1336 DILLINGHAM

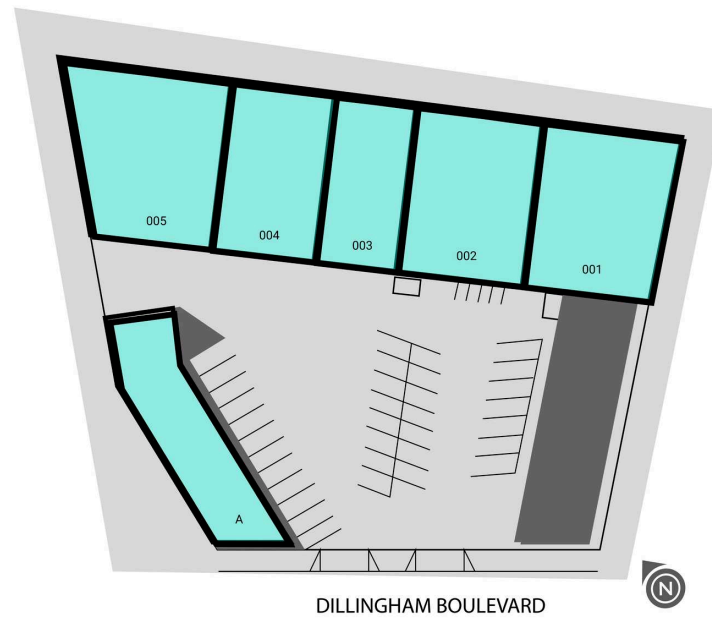

SUITE	Tenant Name	GLA(SF)
A	SIAM RESTAURANTS LLC	3,800 SF
001	JY TRADING CO. INC.	4,944 SF
002	HONOLULU BADMINTON CLUB INC.	5,000 SF
003	JY TRADING CO. INC.	3,000 SF
004	STARKEY AUTOMOTIVE LLC	3,500 SF
005	STARKEY AUTOMOTIVE LLC	5,600 SF