

641 WAIAKAMILO

641 WAIAKAMILO RD, HONOLULU, HI 96817



KAMEHAMEHA SCHOOLS®



This paved and fenced property benefits from high visibility along Waiakamilo Road. Flexible IMX-1 zoning allows for a wide range of uses. Located just 2.3 miles from the Central Business District and minutes away from Honolulu Harbor and major thoroughfares.

FOR LEASING INFORMATION

Anthony Provenzano

(808) 544-1780

aprovenzano@chaneybrooks.com

GLA	DEMOGRAPHICS	1 MILE	3 MILE	5 MILE
31,311	Population	39,182	177,084	319,878
	Total Households	10,205	63,564	119,678
	Average HouseHold Income	\$79,132	\$94,873	\$95,942

641 WAIAKAMILO

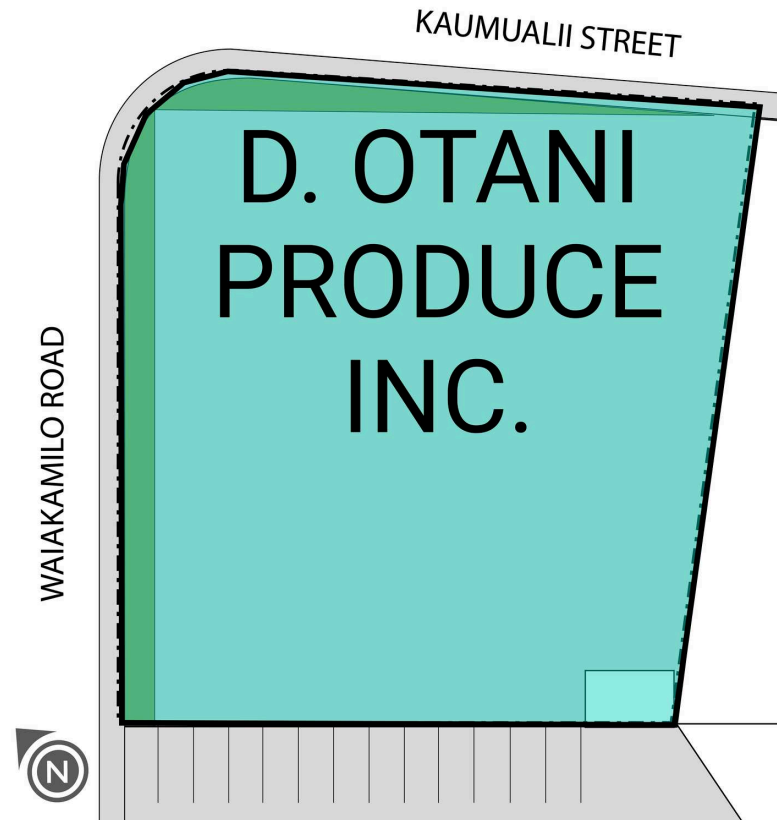

SUITE

Tenant Name

GLA(SF)

1

D. OTANI PRODUCE INC.

31,311 SF