

710 KOHOU

710 KOHOU ST, HONOLULU , HI 96817



KAMEHAMEHA SCHOOLS®



710 Kohou offers high cube warehouse bays and a flexible IMX-1 zoning allowing for a wide range of uses. Easy access to the H-1 freeway and other major roadways like Dillingham Boulevard, North King Street and Nimitz Highway. Only 1.8 miles from Downtown, 2.6 miles from Honolulu Harbor and 4.4 miles from Waikiki.

FOR LEASING INFORMATION

Nick Adler
CBRE
(808) 541-5149
nick.adler@cbre.com

GLA	DEMOGRAPHICS	1 MILE	3 MILE	5 MILE
34,467	Population	44,077	190,213	328,578
	Total Households	12,318	69,677	122,764
	Average HouseHold Income	\$71,645	\$85,136	\$87,593

710 KOHOU

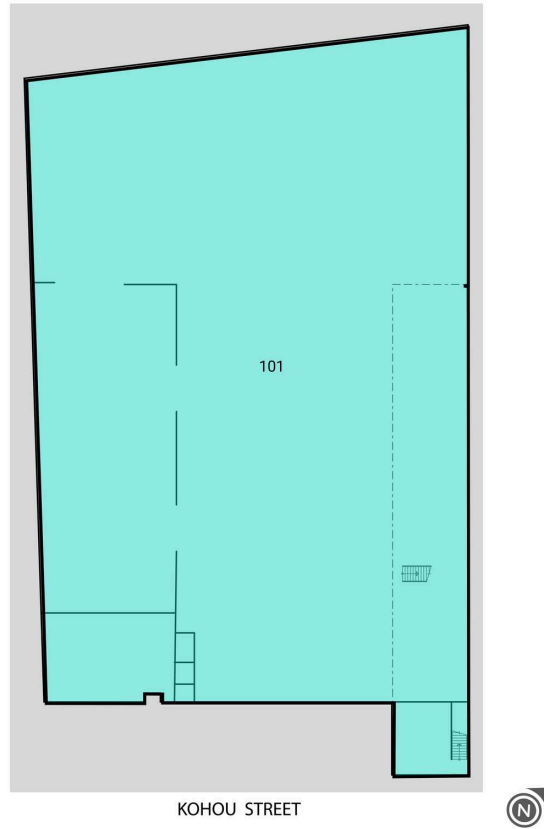

SUITE

Tenant Name

GLA(SF)

101

OCCUPIED

34,467 SF